



Houston Spaceport Phase I Development

November 5, 2015

Presentation to:
Houston City Council
Budget and Fiscal Affairs Committee



**HOUSTON
SPACEPORT**

Houston Spaceport

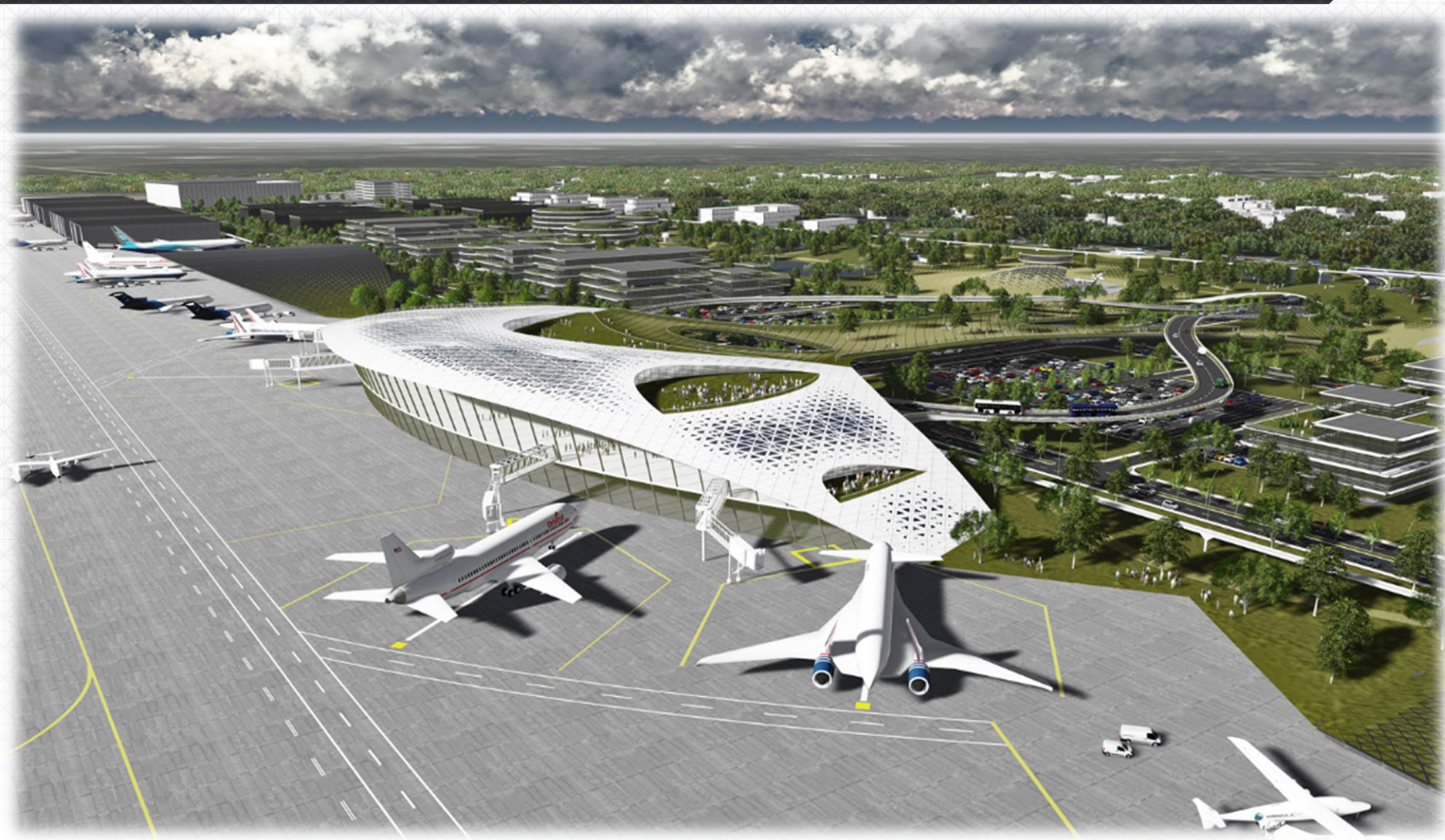



PHASE I DEVELOPMENT



**HOUSTON
SPACEPORT**

Ellington Airport Aerial



Original Spaceport Concept

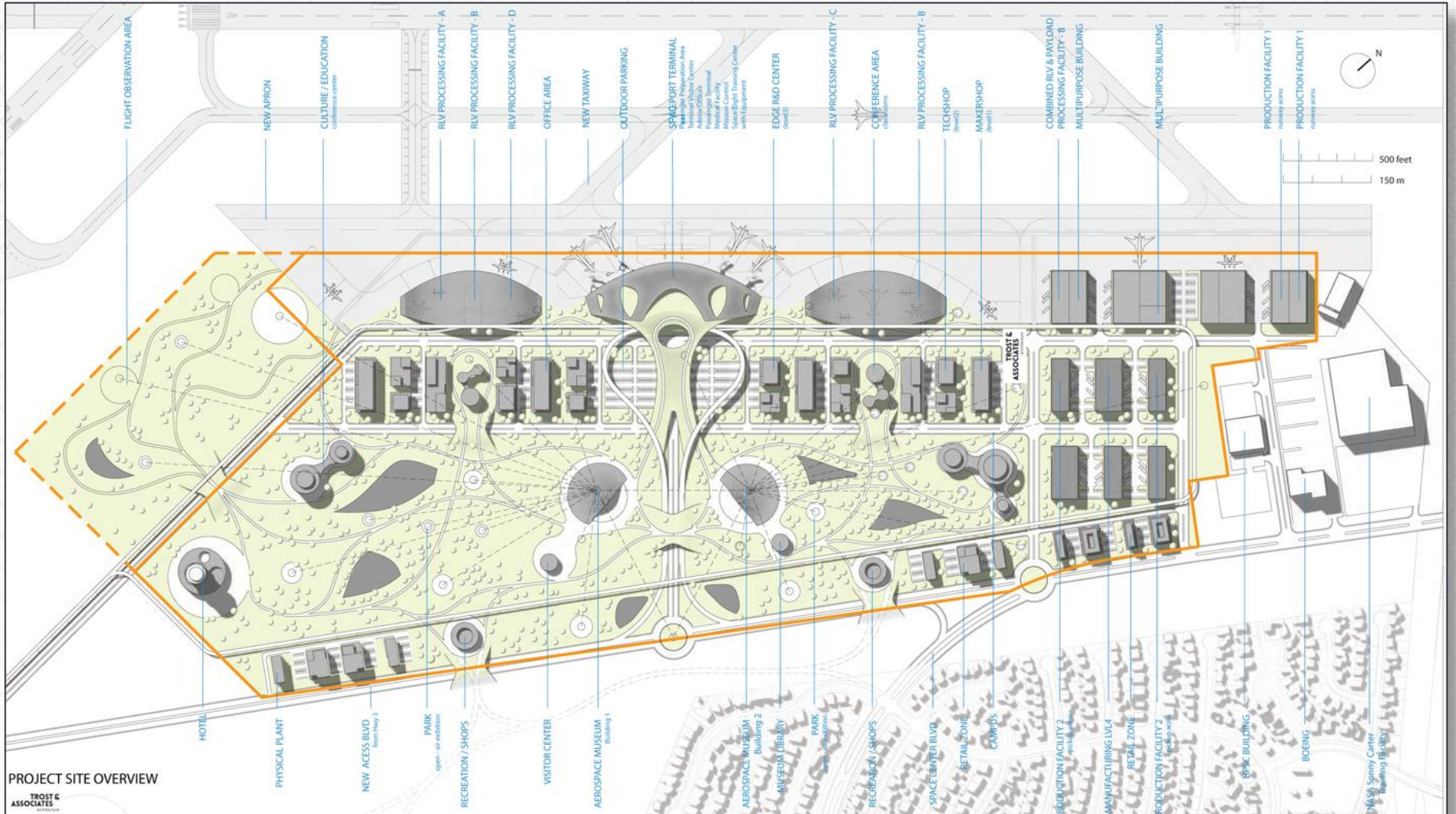

Phase I: Site Organization

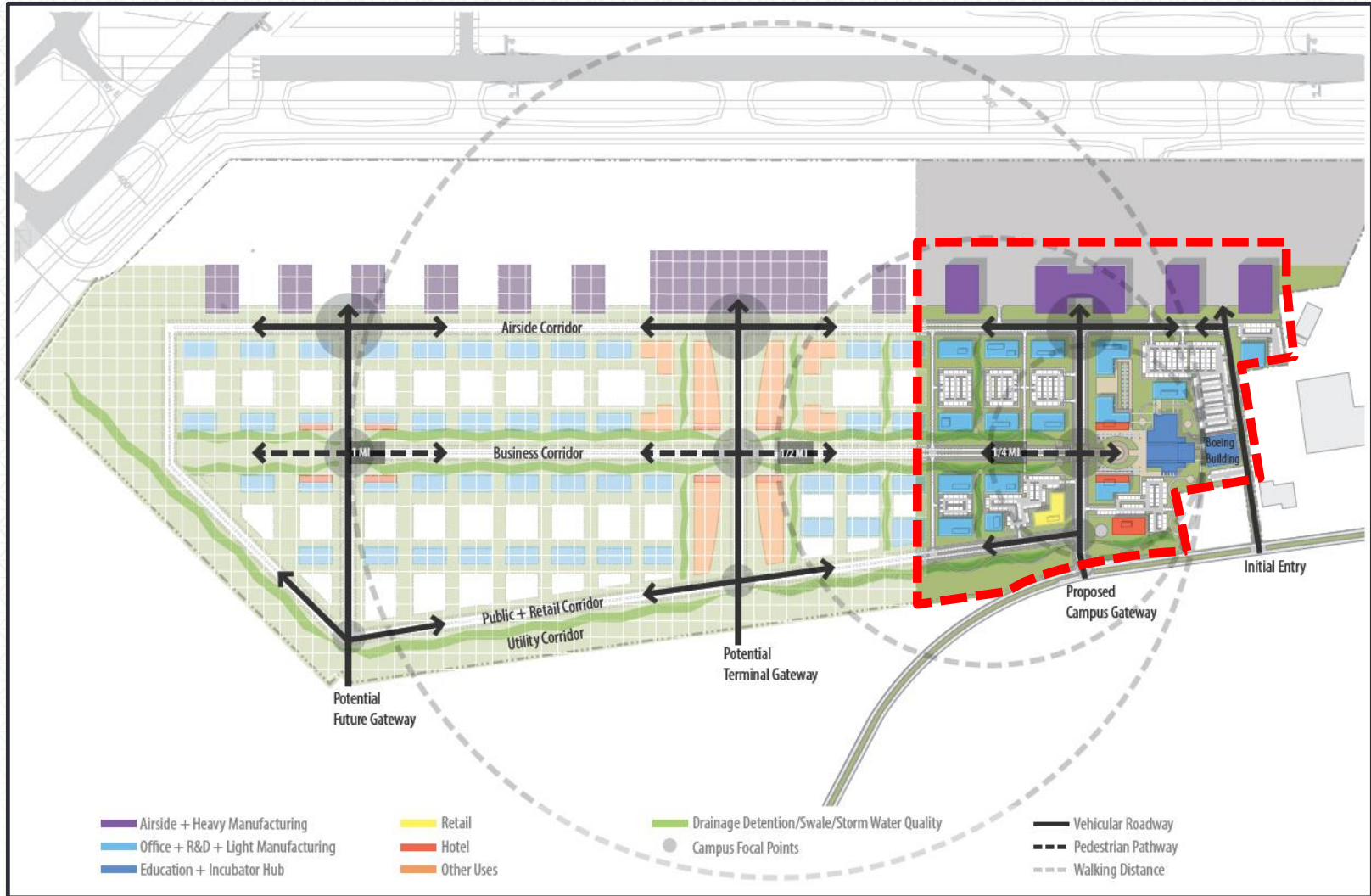

Phase I: Campus Plan

Phase I Quick Facts

- 90 acres of development
- 70 acres of leasable ground
- 1.25m sf of building space
- \$200m of potential building value



Phase I: Typical Street Section



Phase I: Southwest View

Phase I
Incubator
Building

Boeing
Building



Phase I: West View

Phase I
Incubator
Building

Boeing
Building

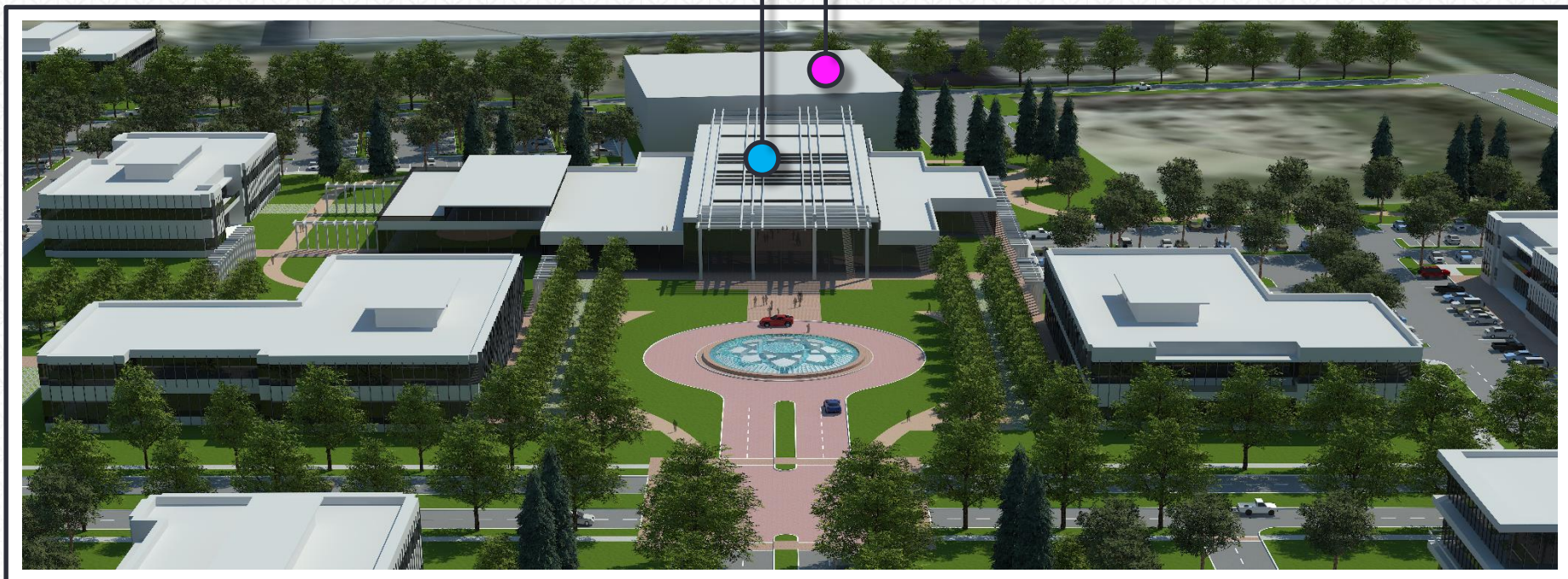

Phase I: Southeast View

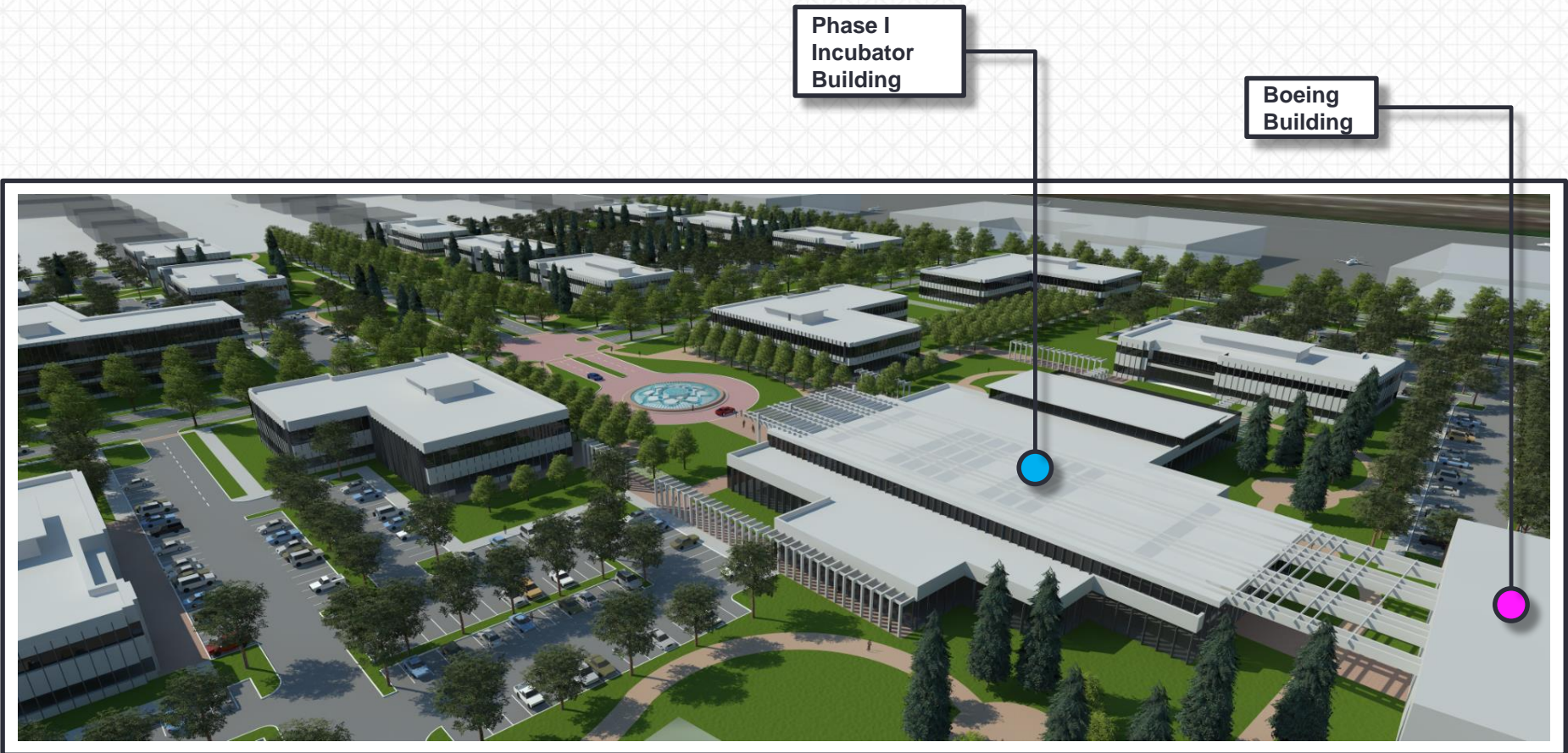

Phase I: Northeast View

Phase I
Incubator
Building





MARKETING AND LEASING ACTIVITIES



**HOUSTON
SPACEPORT**

Cluster of Aerospace Companies

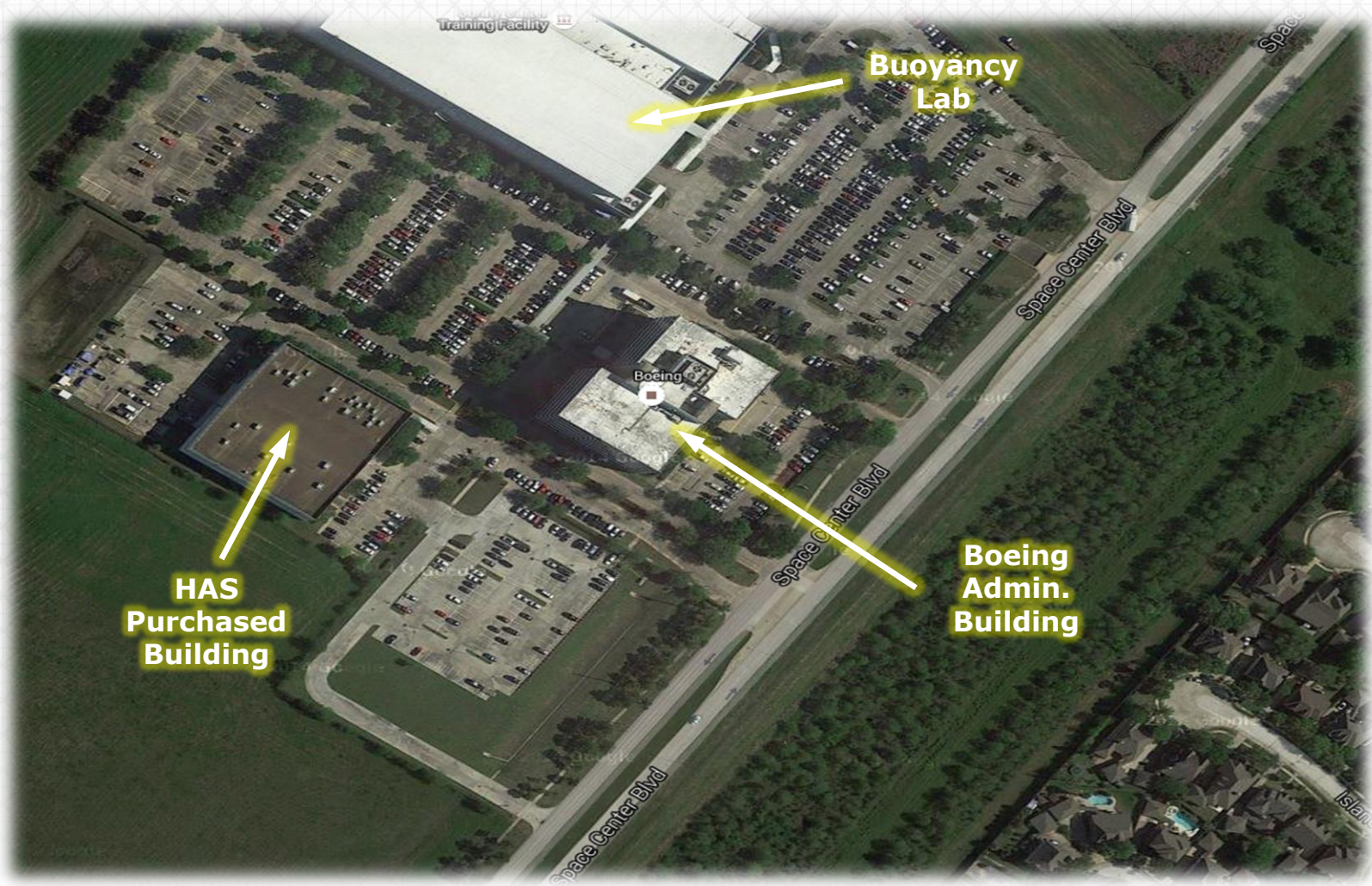

Working Partnerships



Space Commerce Conference



HOUSTON SPACEPORT | HOUSTON AIRPORTS



SPACECOM
SPACE COMMERCE CONFERENCE AND EXPOSITION

HOUSTON SPACEPORT
IS PROUD TO SPONSOR

Nov. 17-19
HOUSTON, TX

COME VISIT US AT BOOTH #309

[LEARN MORE](#)

Houston Spaceport SpaceCom Presence



THANK YOU



**HOUSTON
SPACEPORT**